

PLANTA BAIXA

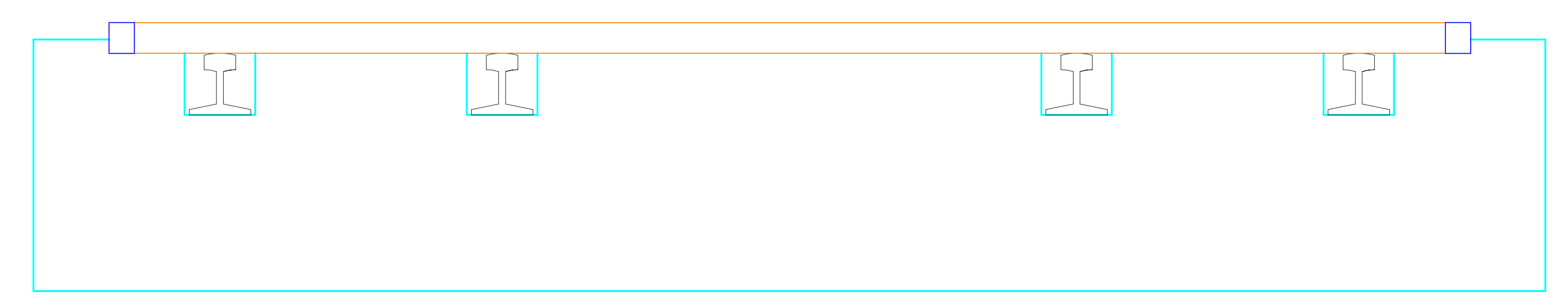

CORTE TRANSVERSAL A-A

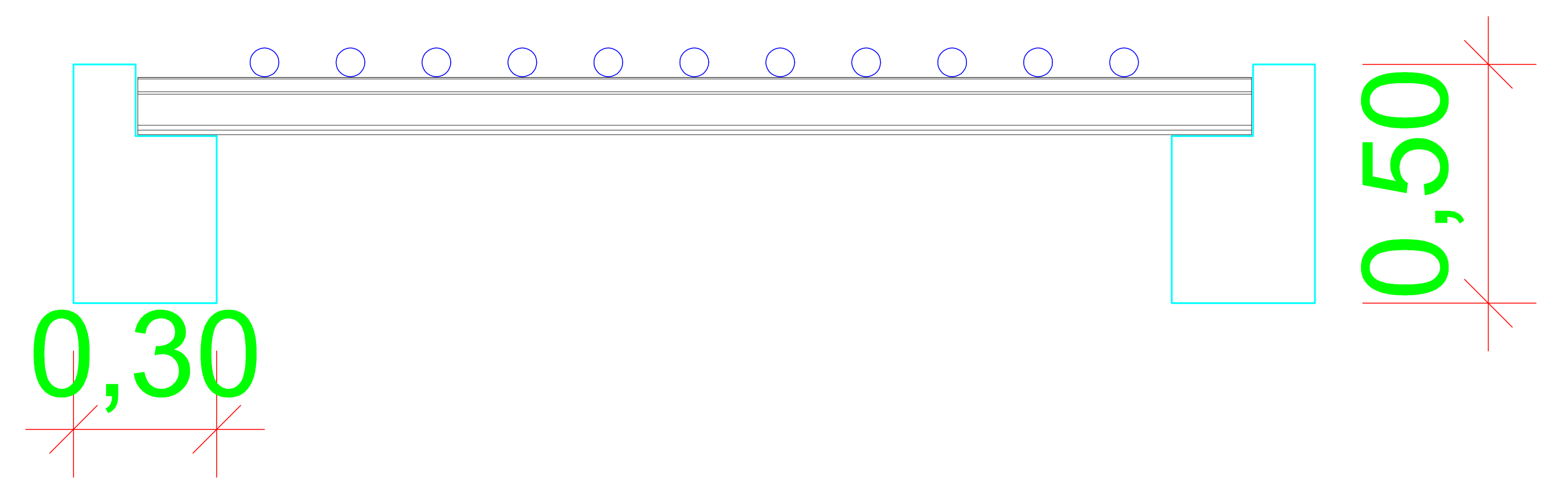

CORTE LONGITUDINAL B-B

MATA-BURRO INTEIRIÇO  
 TRILHO / TUBO COM BASES DE APOIO EM  
 CONCRETO  
 COMPRIMENTO 2,40 m  
 LARGURA 3,00 m

FOLHA 1